



**Murray State University Science Complex
Phase I: Biology
Murray, Kentucky**

Building Square Footage: 66,500 sf
Project Completion: October 2003

The project is the first phase of a three phase science complex on the campus of Murray State University in Kentucky. It consists of two and a half levels of Biology laboratory and classroom space. A two story atrium with monumental stairs is included in the building space.

A reinforced cast-in-place concrete frame was selected for the structural system in order to minimize floor vibrations during microscope usage in the research labs.

The building is designed based on the seismic criteria of the 2000 International Building Code which is much more severe than the requirements of past codes in this area. The lateral system consists of a specially reinforced moment frame to maximize the ductility of the structure.

The building is clad with brick masonry supported by a light gage metal stud backup system.

Owner Contact: Mr. Donald Riley, AIA
Murray State University
615 Gilbert Graves Drives
Murray, KY 42071

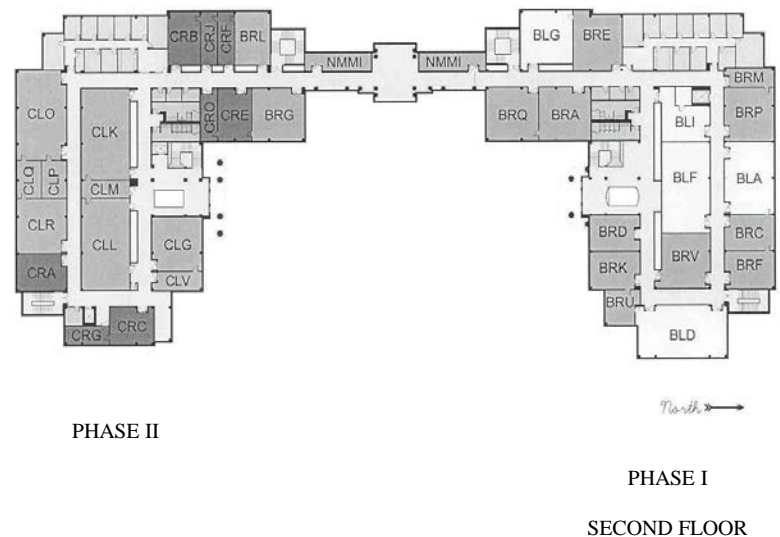
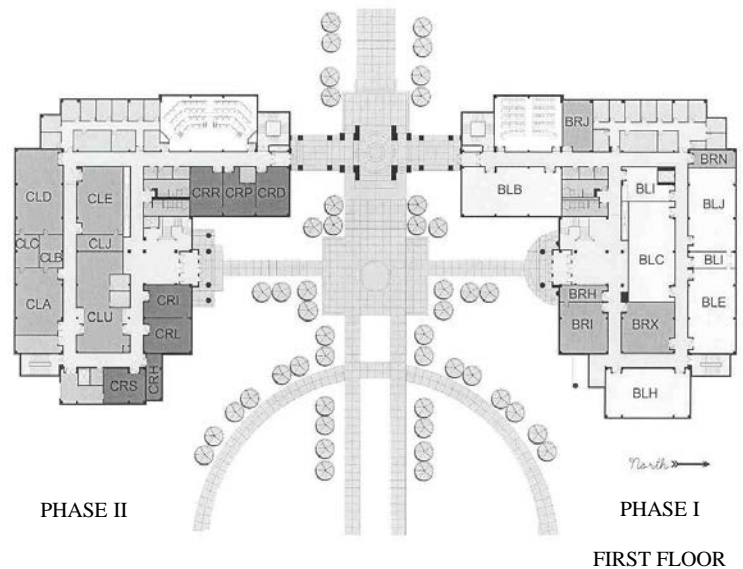

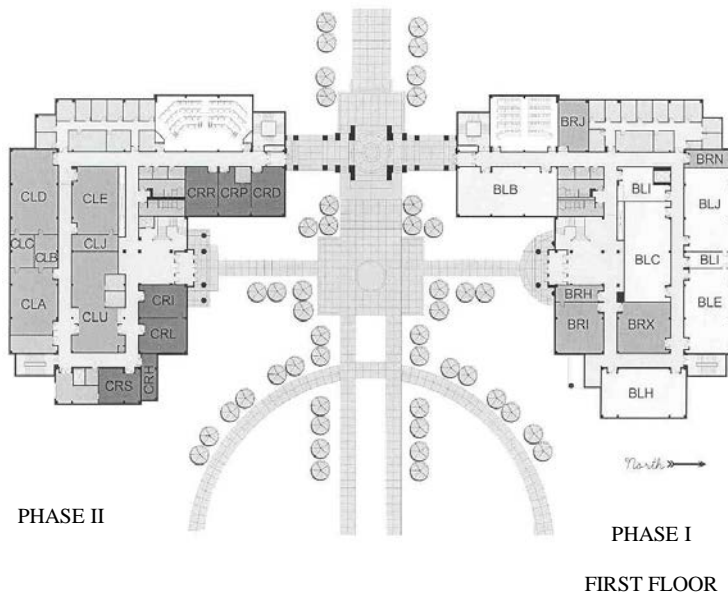

**Murray State University Science Complex
Phase II: Chemistry Building & Connector
Murray, Kentucky**

Building Square Footage: 57,000 sf
Project Completion: 2009

The project is the second phase of a three phase science complex on the campus of Murray State University in Kentucky. It consists of two levels of chemistry laboratory and classroom space. A two story atrium with monumental stairs is included in the building space. The project also includes a 3,000 sq. ft. connector between the Chemistry and Biology buildings.

The building is designed based on the seismic criteria of the 2000 International Building Code which is Seismic Design Category D. The lateral system consists of a specially reinforced moment frame to maximize the ductility of the structure.

A reinforced cast-in-place concrete frame was selected for the structural system in order to minimize floor vibrations during microscope usage in the research labs.

The building is clad with brick masonry supported by a light gage metal stud backup system.

Owner Contact: Dr. Robert 'Bob' Pervine
Associate Dean of Science, Engineering and Technology
615 Gilbert Graves Drive
Murray, KY 42071
270.809.6896
bob.pervine@murraystate.edu

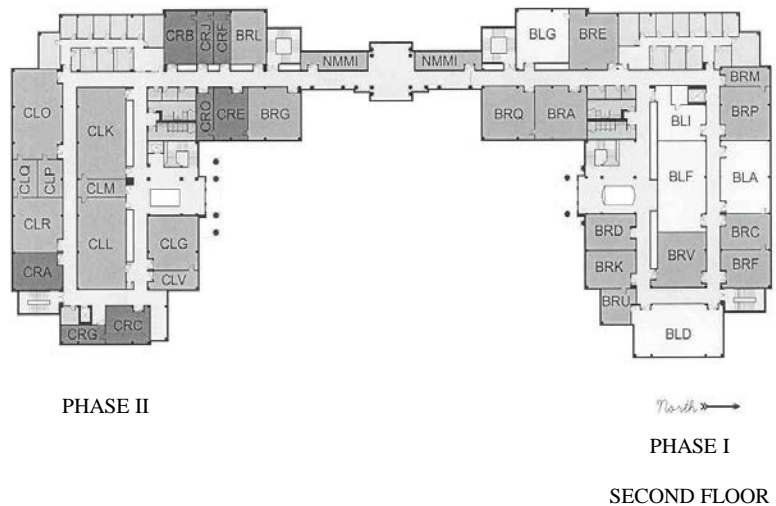



**Murray State University
Science Complex
Phase III Physics
Murray, Kentucky**

The Engineering Physics Building will be a two (2) level, 75,200 SF facility with classrooms, office space, instructional and research labs, high bay spaces and areas for demonstrating sustainable engineering designs. The total square footage above includes 4,500 SF of penthouse level framing. No basement space is anticipated.

The building construction will have 1,500 square feet of connector space between this project and the adjacent building in addition to the space listed above.

Estimated construction costs for the building portion of the project will be just below \$20,220,000.

